

RPI is Your Best Source for Dental Compressor Air Intake Filters

to fit

Air Techniques	Apollo/Midmark®	DentalEZ®/Custom Air/RamVac	Jun-Air
Matrx/Midmark®	MDT McKesson	Midmark®	Tech West Turbine Ind.

For more information about the parts listed in this flyer, see our website www.rpiparts.com

INTAKE FILTER (AIR)

RPI Part #CME074
OEM Part #JA5412500 (Jun-Air)

INTAKE FILTER ELEMENT

- Sold 1 per package (See NOTES below for quantity required for each model)
- 1.36" OD x 3.28" H
- 5 micron paper filter with rubber end caps

NOTES: *Jun-Air:* CA-812 & CA-822 require 1 Intake Filter; CA-825, CA-825Q & CA-825D requires 2 Intake Filters; CA-827D requires 4 Intake Filters; & CA-8212T requires 6 Intake Filters

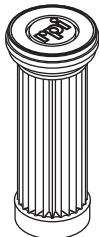

RPI Part #CMK065
OEM Part #89938 & 89831 (Air Techniques)

AIR FILTER ELEMENT KIT

- Sold 1 per package (See NOTES below for quantity required for each model)
- 1.25" OD x 3.74" H
- 10 micron paper filter

NOTES: *Air Techniques:* AirStar® 1, 10 & 10C require 1 air filter each; AirStar® 2-1, 2-2, 21, 21C, 22, 22C, 3, 30 & 30C require 2 air filters each; AirStar® 5, 50 & 50C require 4 air filters each; & AirStar® 7 & 70 require 5 air filters each

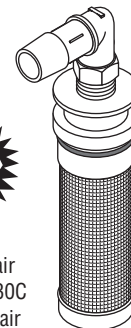

1/4" MPT

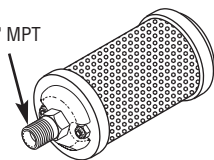

RPI Part #CMF002
OEM Part #80050 (Air Techniques)
& PFM50955 (Apollo/Midmark®)

AIR INTAKE FILTER (METAL STYLE)

- Auto Muffler MO2

RPI Part #CMF014
OEM Part #3-08-0632-10 (MDT McKesson)

FOAM ELEMENT

- Size: 2-1/2" dia. x 4-1/2" long

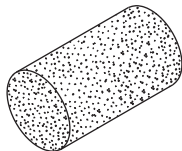

RPI Part #CMF011
OEM Part #60043-1 (Air Techniques)

FOAM ELEMENT

- Size: 4-1/4" diameter x 2" long

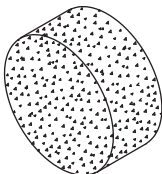

RPI Part #CMF013
OEM Part #77007079 (Matrx/Midmark®) & AAF-100 (Tech West Turbine Ind.)

FOAM ELEMENT

- Size: 2" diameter x 2" long

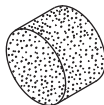

RPI Part #CMF075
OEM Part #JA5412400 (Jun-Air)

INTAKE FILTER

- 5 micron polyester filter

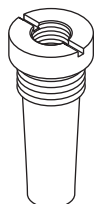

RPI Part #CMA068
OEM Part #TAF-100 (Tech West Turbine Ind.)

AIR FILTER ASSEMBLY

- Includes Air Filter Element (RPI Part #CME067)

Fits: 1 HP Compressor Head

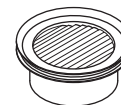
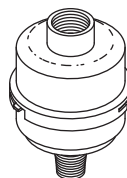

RPI Part #CME067
OEM Part #003965 (DentalEZ®/Custom Air/RamVac) & TIF-100 (Tech West Turbine Ind.)

AIR FILTER ELEMENT

- 2 micron paper filter

Fits: Air Filter Assembly

RPI Part #CMA070
OEM Part #TAF-200 (Tech West Turbine Ind.)

AIR FILTER ASSEMBLY

- Includes Air Filter Element (RPI Part #CME069)

Fits: 2 HP Compressor Head

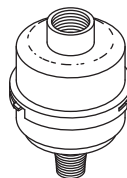

RPI Part #CME069
OEM Part #TIF-200 (Tech West Turbine Ind.)

AIR FILTER ELEMENT

- 2 micron paper filter

Fits: Air Filter Assembly

RPI Part #CMA072
OEM Part #004006 (DentalEZ®/Custom Air/RamVac)

AIR FILTER ASSEMBLY

- Includes Air Filter Element (RPI Part #CME080)

Fits: 1 HP Compressor Head

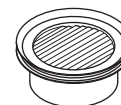
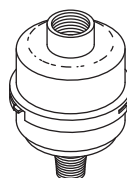

RPI Part #CME080
OEM Part #003965 (DentalEZ®/Custom Air/RamVac)

AIR FILTER ELEMENT

- 25 micron polyester filter

Fits: Air Filter Assembly

Air Techniques, Apollo/Midmark®, DentalEZ®/Custom Air/RamVac, Jun-Air, Matrx/Midmark®, MDT McKesson, Midmark®, & Tech West/Turbine Industries



replacement parts industries, inc.

CALL (800) 221-9723 • FAX (818) 882-7028 • EMAIL order@rpiparts.com • WEBSITE www.rpiparts.com

The above parts are manufactured by Replacement Parts Industries, Inc. to fit the equipment noted. All product names used in this document are trademarks or registered trademarks of their respective holders. Web 01/11



INTAKE FILTER (FRESH AIR)

RPI Part #CME071
OEM Part #77001541 (Matrix/Midmark®)

AIR FILTER ELEMENT

- Sold 1 per package (See NOTES below for quantity required for each model)
- Used for Fresh Air intake
- Includes Rubber Air Filter Cap

Fits: Compressor heads

NOTES: Matrix: OL-2000 & OL2001 requires (2), OL4000 requires (4) & OL-6000 requires (6)

Midmark: P52 requires (4) & P72 requires (6)

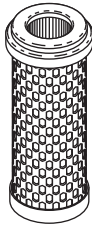

RPI Part #CMF073
OEM Part #JA5413210 (Jun-Air)

AIR INTAKE FILTER

- Sold 1 per package (See NOTES below for quantity required for each model)

- 5 micron polyester filter
- 1.58" OD x 2.39 H plastic housing
- Includes: 10.50" of .38" OD clear tubing

Fits: Compressor Head Assembly

NOTES: DentalEz / Custom Air / RamVac: CA-711 & CA721 require (1), CA-713 & CA-723 requires (2) and CA-725 requires (4)

Jun-Air: CA-711 & CA721 require (1), CA-713 & CA-723 requires (2) and CA-725 requires (4)

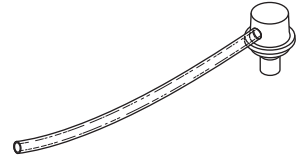

RPI Part #CMK003
OEM Part #PFM50955 (Apollo/Midmark®)
& ACP90505 (Midmark®)

FRESH AIR INTAKE FILTER KIT

- Includes filter housing, (2) Uniclamp (RPI Part #RPC442), PVC Tubing (RPI Part #RPT441), Cap (RPI Part #RPC443), Filter (RPI Part #CME004) and PM sticker

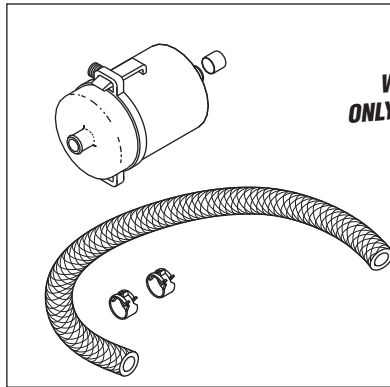

**THE RPI ADVANTAGE!
WITH THE RPI INTAKE FILTER KIT,
ONLY THE FILTER NEEDS REPLACEMENT -
NOT THE ENTIRE ASSEMBLY!**

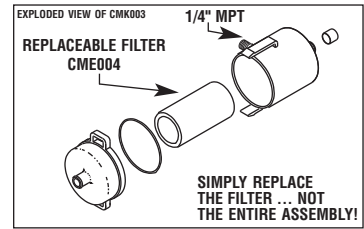

RPI Part #CME004
OEM Part #'s - Fits RPI Part #CMK003 only

REPLACEMENT FILTER ELEMENT

- Replacement filter element for (RPI Part #CMK003) only
- Includes O-ring and PM sticker
- 1.56" OD x 2.96" long

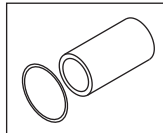

RPI Part #RPT441
OEM Part #PFM50955 (Complete Filter Kit)

PVC TUBING - CLEAR

- .50" ID x .728" OD
- Sold by the foot (reel not included)
- Replacement for tubing included in Fresh Air Intake Filter Kit (RPI Part #CMK003)

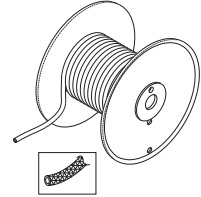

RPI Part #RPC443
OEM Part #PFM50955 (Complete Filter Kit)

CAP

- 6 per package; 1/2" ID; Black textured
- Replacement for cap included in Fresh Air Intake Filter Kit (RPI Part #CMK003)



RPI Part #RPC442
OEM Part #PFM50955 (Complete Filter Kit)

UNICLAMP

- 6 per package; Fits 3/4" OD tubing
- Replacement for uniclamp included in Fresh Air Intake Filter Kit (RPI Part #CMK003)



Don't forget ... RPI has these parts and more to fit Dental Compressors!

- | | | |
|-----------------------------------|------------------------------------|--------------------------------|
| • Air Intake Filters and Elements | • Desiccants | • Pressure Switches and Valves |
| • Air Filter Assemblies | • Differential Pressure Indicators | • Pressure Gauges |
| • Carbon Filter Elements | • Fresh Air Intake Filters | • Run Capacitors |
| • Coalescing Filter Assemblies | • Moisture Indicators | • Safety Valves |
| • Coalescing Filter Elements | • Mounting Brackets | • Sight Glasses |
| • Compressor Oil | • Particle Filter Assemblies | • Start Boxes |
| • Compressor PM Kit | • Particle Filter Elements | • Start Capacitors |
| • Cooling Fans | • Purge Filters and Mufflers | • Thermal Protector Assemblies |